

## 10 173 224 30 GROHE CUBE BASIN MIXER 1/2" S-SIZE

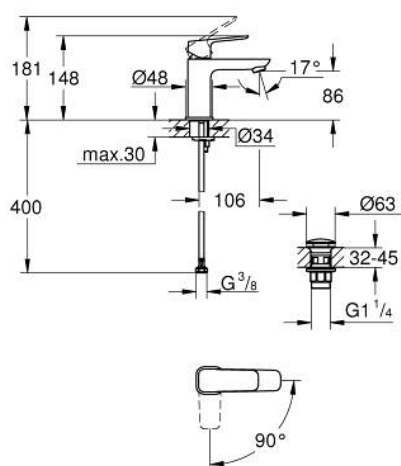

### PRODUCT DESCRIPTION

- Colour: matte black
- single hole installation
- metal lever
- GROHE SilkMove Energy Saving 28 mm ceramic cartridge with energy saving function via cold start
- adjustable flow rate limiter
- with temperature limiter
- GROHE Water Saving - Less water, perfect flow
- maximum flow rate (at 3 bar): 5 l/min
- GROHE FastFixation installation system
- smooth body with push-open pop-up waste set 1 1/4"
- flexible connection hoses

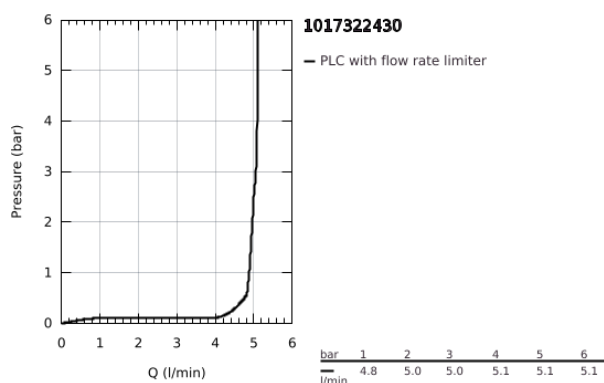

# 10 173 224 30 GROHE CUBEO BASIN MIXER 1/2" S-SIZE

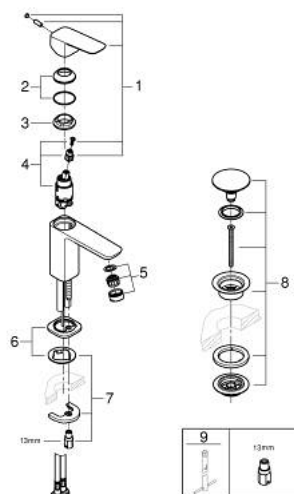

## SPARE PARTS

- 1: lever (Spare part-nr. 1060182430)
- 2: cap (Spare part-nr. 465812430)
- 3: retaining ring (Spare part-nr. 07419000)
- 4: Cubeo Catridge (Spare part-nr. 1060179990)
- 5: Mousseur (Spare part-nr. 481592430)
- 6: Cubeo Rosette (Spare part-nr. 1060152430)
- 7: Shank mounting kit (Spare part-nr. 46671000)
- 8: Waste set with push-open plug (Spare part-nr. 658072430)
- 9: Mounting wrench (Spare part-nr. 19017000)\*

\* Optional accessories