

19 809 001 COSTA L CONCEALED VALVE EXPOSED PART

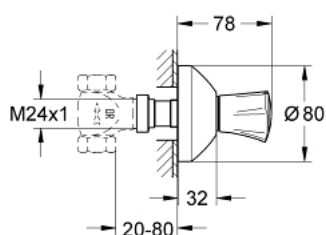

PRODUCT DESCRIPTION

- Tyc: Chrome
- trim set for 35 028 000
- for GROHE concealed valves, 1/2", 3/4", 1"
- installation depth infinitely adjustable 20-80 mm
- escutcheon with wall sealing
- screwable
- metal handle
- heat insulated
- marking: red
- GROHE LongLife finish



19 809 001 COSTA L CONCEALED VALVE EXPOSED PART

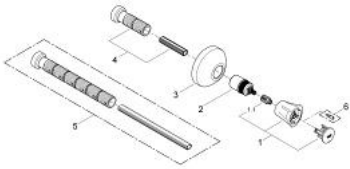

SPARE PARTS

- 1: Handle (Spare part-nr. 45994000)
- 1.1: Snap insert (Spare part-nr. 0538600M)
- 2: Extension for spindle (Spare part-nr. 45204000)
- 3: Escutcheon (Spare part-nr. 45219000)
- 4: Extension set, 80 mm (Spare part-nr. 45202000)
- 5: Extension set 200 mm (Spare part-nr. 45203000)*
- 6: Screw for Costa/Avina products (Spare part-nr. 48013000)*

* Optional accessories