

20 421 000 BAUEDGE PILLAR TAP 1/2" XS-SIZE

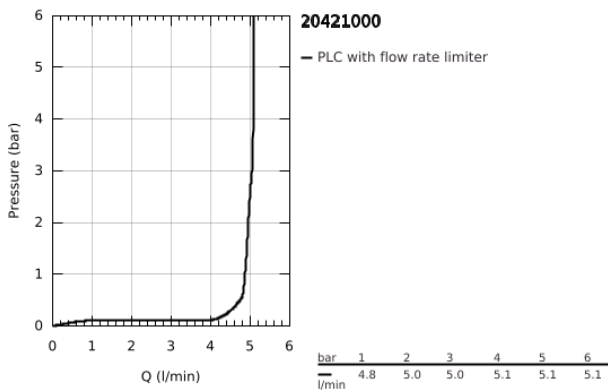

PRODUCT DESCRIPTION

- Colour: chrome
- single hole installation
- metal lever
- ceramic headpart 1/2", 90°
- GROHE LongLife finish
- GROHE EcoJoy - less water, perfect flow
- maximum flow rate (at 3 bar): 5 l/min
- fixation nut G 1/2"

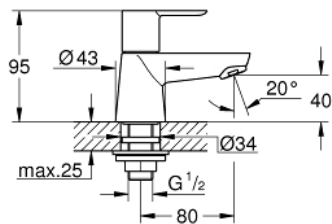

20 421 000 BAUEDGE PILLAR TAP 1/2" XS-SIZE

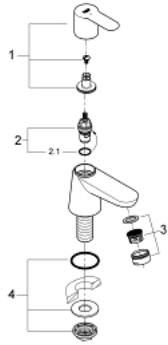

SPARE PARTS

- 1: Lever (Spare part-nr. 48028000)
- 1.1: Replacement handle connection kit (Spare part-nr. 45186000)
 - 1.1.1: O-Ring $\varnothing 18,2 \times \varnothing 1,7$ (Spare part-nr. 0392400M)
- 2: Ceramic headpart 1/2" (Spare part-nr. 45882000)
 - 2.1: O-Ring $\varnothing 18,2 \times \varnothing 1,7$ (Spare part-nr. 0392400M)
- 3: Mousseur (Spare part-nr. 13952000)
- 4: Shank mounting kit (Spare part-nr. 45004000)