

26 381 001 TEMPESTA SYSTEM 210 FLEX SHOWER SYSTEM WITH DIVERTER FOR WALL MOUNTING

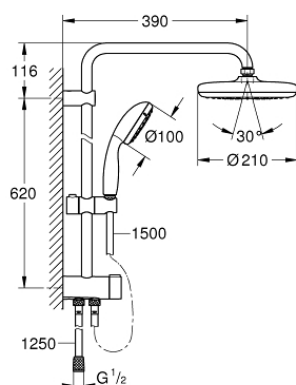

PRODUCT DESCRIPTION

- Tyc: Chrome
- consisting of:
 - horizontal 390 mm shower arm, adjustable before installation
 - change by diverter between hand shower, head shower or head shower
- Eco setting
- head shower Tempesta 210 (26 408)
- 2 spray patterns (via diverter):
 - Rain, SmartRain
- chrome plated spray face
- with ball joint
- rotation angle $\pm 15^\circ$
- hand shower Tempesta 100 (27 852)
- spray pattern: Rain
- adjustable in height with gliding element
- distance between diverter and upper bracket: 620 mm
- Relaxaflex shower hose 1500 mm (28 151)
- Relaxaflex shower hose 1250 mm (28 150)
- flexible installation: connection to faucet / wall union for water supply with 1/2" thread of the 1250 mm shower hose
- GROHE DreamSpray perfect spray pattern
- GROHE Long-Life finish
- SpeedClean anti-limescale system
- Inner WaterGuide for a longer life
- ShockProof silicone ring prevents damage caused by a shower falling
- suitable for instantaneous heaters from 18 kW/h
- minimum flow rate 7 l/min

26 381 001 TEMPESTA SYSTEM 210 FLEX SHOWER SYSTEM WITH DIVERTER FOR WALL MOUNTING

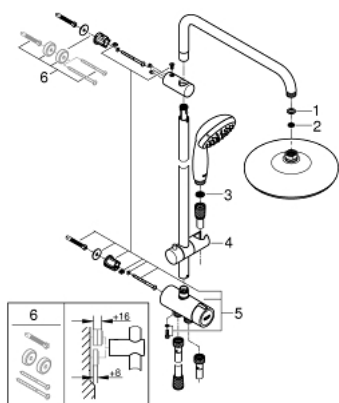

SPARE PARTS

- 1: Fibre seal Ø 18,5 x Ø 12 x 2 (Spare part-nr. 0138900M)
- 2: Dirt strainer (Spare part-nr. 48007000)
- 3: Dirt strainer (Spare part-nr. 0700200M)
- 4: Glide element (Spare part-nr. 12140000)
- 5: Diverter (Spare part-nr. 48338000)
- 6: Compensation disc (Spare part-nr. 26496000)*
- * Optional accessories