

## 26 507 GN0 EUPHORIA SMARTCONTROL SYSTEM 310 SHOWER SYSTEM WITH THERMOSTAT FOR WALL MOUNTING

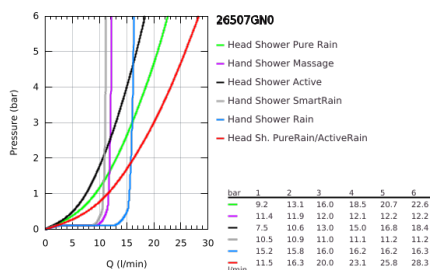
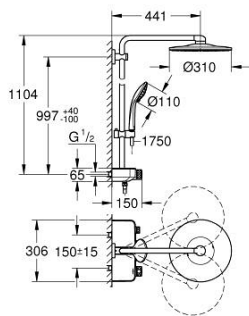

### PRODUCT DESCRIPTION

- Colour: brushed cool sunrise
- consisting of:
  - horizontal 450 mm shower arm
  - upper bracket adjustable for minimal adaption to existing drilling holes
  - exposed SmartControl thermostat
- allows change between:
  - head shower Rainshower SmartActive 310
  - spray patterns: GROHE PureRain, ActiveRain
  - maximum flow rate (at 3 bar): 20 l/min
  - hand shower Euphoria 110 Massage, spray plate white
  - spray patterns: Rain, SmartRain, Massage
  - maximum flow rate (at 3 bar): 16 l/min
  - adjustable in height with gliding element
  - shower hose Silverflex 1750 mm 1/2" x 1/2" (28 388)
  - GROHE DreamSpray - perfect spray pattern
  - GROHE LongLife finish
  - GROHE CoolTouch - no risk of scalding
  - GROHE TurboStat - compact cartridge with wax thermoelement
  - GROHE ProGrip - with knurled structure
  - GROHE SafeStop at 38°C
  - GROHE SafeStop Plus - optional temperature limiter at 43°C included
  - GROHE SmartControl - control the shower with intuitive push/turn button
  - integrated GROHE EasyReach shower tray
  - GROHE SpeedClean - effortless limescale removal
  - Inner WaterGuide - inner insulation for surface protection
  - TwistStop - to prevent hose from twisting
  - suitable for instantaneous heaters from 18 kW/h
  - minimum flow rate 5 l/min

## 26 507 GN0 EUPHORIA SMARTCONTROL SYSTEM 310 SHOWER SYSTEM WITH THERMOSTAT FOR WALL MOUNTING



### SPARE PARTS

- 1: Thermostatic compact cartridge 1/2" (Spare part-nr. 47439000)
  - 2: Cartridge (Spare part-nr. 48297000)
  - 3: Non-return valve (Spare part-nr. 49069000)
  - 4: Non-return valve (Spare part-nr. 08565000)
  - 5: Glide element (Spare part-nr. 48177GN0)
  - 6: Dirt strainer (Spare part-nr. 0700200M)
  - 7: Shower rail holder (Spare part-nr. 48279GN0)
  - 9: GROHE TurboStat cartridge 1/2" (Spare part-nr. 47175000)\*
  - 10: Socket spanner (Spare part-nr. 49059000)\*
- \* Optional accessories