

26 508 000 EUPHORIA SMARTCONTROL SYSTEM 310 CUBE DUO SHOWER SYSTEM WITH THERMOSTAT FOR WALL MOUNTING

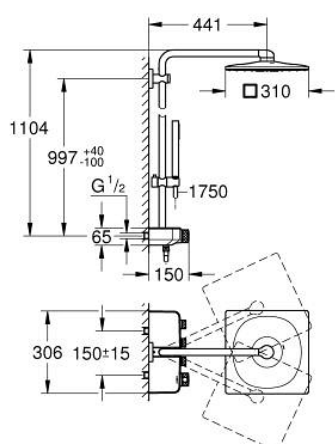

PRODUCT DESCRIPTION

- Tyc: Chrome
- consisting of:
 - horizontal 450 mm shower arm
 - upper bracket adjustable for minimal adaption to existing drilling holes
 - exposed SmartControl thermostat
- allows change between:
 - head shower Rainshower SmartActive 310 Cube
- 2 spray patterns:
 - GROHE PureRain, ActiveRain
- maximum flow rate (at 3 bar): 20 l/min
- hand shower Euphoria Cube Stick (27 699)
 - maximum flow rate (at 3 bar): 16 l/min
- adjustable in height with gliding element
- Silverflex shower hose 1750 mm 1/2" x 1/2" (28 388)
- GROHE DreamSpray perfect spray pattern
- GROHE CoolTouch no risk of scalding
- GROHE TurboStat compact cartridge with wax thermoelement
- GROHE ProGrip with knurl structure
- GROHE Long-Life finish
- GROHE SafeStop at 38°C
- GROHE SafeStop Plus optional temperature limiter at 43°C included
- GROHE SmartControl push for ON-OFF, turn for volume adjustment from GROHE Water Saving to Full Flow
- integrated GROHE EasyReach shower tray
- SpeedClean anti-limescale system
- Inner WaterGuide for a longer life
- TwistStop to prevent hose from twisting
- suitable for instantaneous heaters from 18 kW/h
- minimum flow rate 7 l/min

26 508 000 EUPHORIA SMARTCONTROL SYSTEM 310 CUBE DUO SHOWER SYSTEM WITH THERMOSTAT FOR WALL MOUNTING



SPARE PARTS

- 1: Thermostatic compact cartridge 1/2" (Spare part-nr. 47439000)
- 2: Cartridge (Spare part-nr. 48297000)
- 3: Non-return valve (Spare part-nr. 49069000)
- 4: Non-return valve (Spare part-nr. 08565000)
- 5: Glide element (Spare part-nr. 48177000)
- 6: Dirt strainer (Spare part-nr. 0700200M)
- 7: Shower rail holder (Spare part-nr. 48279000)
- 8: Compensation disc (Spare part-nr. 27180000)*
- 9: GROHE TurboStat cartridge 1/2" (Spare part-nr. 47175000)*
- 10: Socket spanner (Spare part-nr. 49059000)*
- 11: Shower system pipe for retrofitting (Spare part-nr. 48497000)*
- 12: Shower system pipe for retrofitting (Spare part-nr. 48498000)*

* Optional accessories