

26 512 000 EUPHORIA SMARTCONTROL SYSTEM DUO SHOWER SYSTEM WITH BATH THERMOSTAT FOR WALL MOUNTING

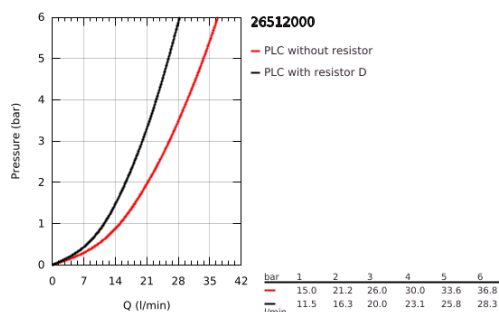

PRODUCT DESCRIPTION

- Colour: chrome
- consisting of:
 - horizontal 450 mm shower arm*
 - upper bracket adjustable for minimal adaption to existing drilling holes
 - exposed SmartControl bath thermostat
 - allows change between:
 - head shower and hand shower (to be ordered separately)**
 - with ball joint
 - rotation angle $\pm 15^\circ$
 - bath inlet
 - adjustable in height with gliding element
- Rotaflex Metal Long-Life TwistStop shower hose 1750 mm (28 025)
- GROHE DreamSpray perfect spray pattern
- GROHE Long-Life finish
- GROHE CoolTouch no risk of scalding
- GROHE TurboStat compact cartridge with wax thermoelement
- GROHE ProGrip with knurl structure
- GROHE Water Saving - Less water, perfect flow
- GROHE SafeStop safety button at 38°C
- GROHE SafeStop Plus optional temperature limiter at 43°C included
- GROHE SmartControl push for ON-OFF, turn for volume adjustment from GROHE Water Saving to Full Flow
- integrated GROHE EasyReach shower tray
- SpeedClean anti-limescale system
- Inner WaterGuide for a longer life
- TwistStop to prevent hose from twisting
- suitable for instantaneous heaters from 18 kW/h
- minimum flow rate 7 l/min
- * weight of head shower up to 2 kg acceptable
- ** recommendation: Euphoria 260 SmartControl 6 l/min (26 456), Euphoria Massage 6.4 l/min (26 513 000)



26 512 000 EUPHORIA SMARTCONTROL SYSTEM DUO SHOWER SYSTEM WITH BATH THERMOSTAT FOR WALL MOUNTING

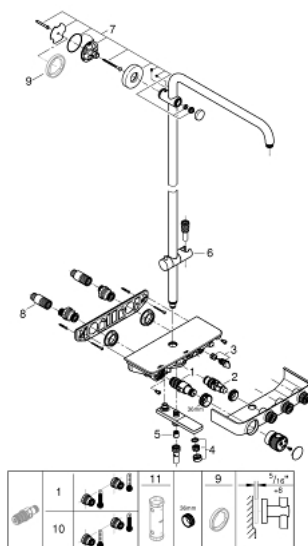

SPARE PARTS

- 1: Thermostatic compact cartridge 1/2" (Spare part-nr. 49110000)
- 2: Cartridge (Spare part-nr. 48297000)
- 3: Non-return valve (Spare part-nr. 49069000)
- 4: Flow restrictor (Spare part-nr. 13941000)
- 5: Non-return valve (Spare part-nr. 08565000)
- 6: Sliding piece (Spare part-nr. 48177000)
- 7: Outlet shower holder (Spare part-nr. 48279000)
- 8: Spacer (Spare part-nr. 27180000)*
- 9: GROHE TurboStat cartridge 1/2" (Spare part-nr. 47175000)*
- 10: Socket Spanner (Spare part-nr. 49059000)*

* Optional accessories