

26 723 000 EUPHORIA SYSTEM 310 SHOWER SYSTEM WITH THERMOSTATIC MIXER FOR WALL MOUNTING

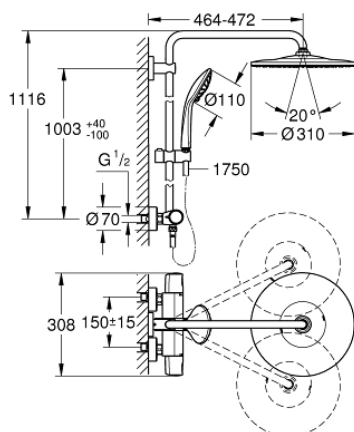

PRODUCT DESCRIPTION (1/2)

- Tyc: Chrome
- consisting of:
 - horizontal swivable 450 mm shower arm
 - exposed thermostat with Aquadimmer function
 - allows change between:
 - head shower Rainshower Mono 310 (26 562)
 - spray pattern:
 - GROHE PureRain
 - maximum flow rate (at 3 bar): 8 l/min
 - with ball joint
 - rotation angle $\pm 15^\circ$
 - hand shower Euphoria 110 Massage (27 239)
 - 3 spray patterns:
 - Rain, Massage, SmartRain
 - maximum flow rate (at 3 bar): 8 l/min
 - adjustable in height with gliding element
 - Silverflex shower hose 1750 mm 1/2" x 1/2" (28 388)
 - GROHE TurboStat compact cartridge with wax thermoelement
 - GROHE SafeStop safety button at 38°C (calibration required)
 - GROHE SafeStop Plus optional temperature limiter at 43°C included
 - GROHE CoolTouch no risk of scalding
 - GROHE MetalGrip ergonomically shaped metal handles
 - GROHE DreamSpray perfect spray pattern
 - GROHE Long-Life finish
 - GROHE SprayDimmer (stepless flow rate reduction)
 - GROHE Water Saving - Less water, perfect flow
 - GROHE FastFixation upper bracket adjustable
 - Inner WaterGuide for a longer life
 - SpeedClean anti-limescale system
 - TwistStop to prevent hose from twisting
 - suitable for instantaneous heaters from 18 kW/h
 - minimum flow rate 5 l/min
 - optional upgrade: GROHE EasyReach tray (26 362), sold separately

Pure Freude
an Wasser



26 723 000 **EUPHORIA SYSTEM 310 SHOWER SYSTEM WITH THERMOSTATIC MIXER FOR WALL MOUNTING**

PRODUCT DESCRIPTION (2/2)

- professional exclusive

26 723 000 EUPHORIA SYSTEM 310 SHOWER SYSTEM WITH THERMOSTATIC MIXER FOR WALL MOUNTING

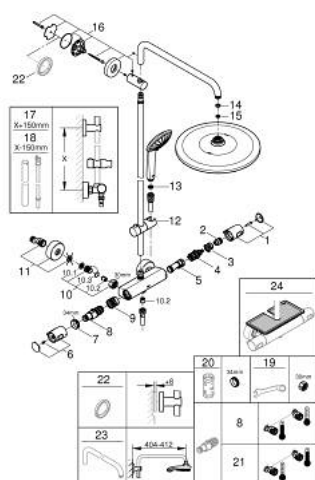

SPARE PARTS

- 1: Shut-off handle (Spare part-nr. 47991000)
- 2: Stop ring (Spare part-nr. 47986000)
- 3: Stop ring (Spare part-nr. 47965000)
- 4: Aquadimmer (Spare part-nr. 47364000)
- 5: Water flow (Spare part-nr. 47887000)
- 6: Handle (Spare part-nr. 47992000)
- 7: Fitting ring (Spare part-nr. 47743000)
- 8: Thermostatic compact cartridge 1/2" (Spare part-nr. 47439000)
- 9: Race (Spare part-nr. 47975000)
- 10: Non-return valve (Spare part-nr. 47189000)
- 10.1: Dirt strainer (Spare part-nr. 0726400M)
- 10.2: Non-return valve (Spare part-nr. 08565000)
- 10.3: O-ring $\varnothing 17 \times \varnothing 2$ (Spare part-nr. 0305500M)
- 11: S-union (Spare part-nr. 12662000)
- 12: Glide element (Spare part-nr. 12140000)
- 13: Dirt strainer (Spare part-nr. 0700200M)
- 14: Fibre seal $\varnothing 18,5 \times \varnothing 12 \times 2$ (Spare part-nr. 0138900M)
- 15: Dirt strainer (Spare part-nr. 48007000)
- 16: Shower rail holder (Spare part-nr. 48279000)
- 17: Shower system pipe for retrofitting (Spare part-nr. 48514000)*
- 18: Shower system pipe for retrofitting (Spare part-nr. 48515000)*
- 19: Special spanner (Spare part-nr. 19377000)*
- 20: Socket spanner (Spare part-nr. 19332000)*
- 21: GROHE TurboStat cartridge 1/2" (Spare part-nr. 47175000)*
- 22: Compensation disc (Spare part-nr. 27180000)*
- 23: Shower arm for shower systems (Spare part-nr. 14047000)*
- 24: GROHE EasyReach tray (Spare part-nr. 26362LN1)*

* Optional accessories