

30 505 DC0 ESSENCE SINGLE-LEVER SINK MIXER 1/2"

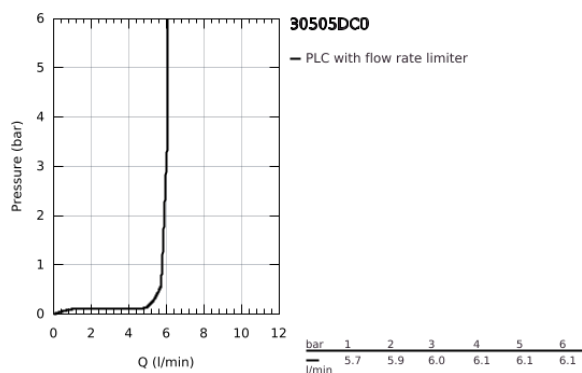

PRODUCT DESCRIPTION

- Colour: supersteel
- high spout
- single hole installation
- GROHE Long-Life finish
- GROHE SilkMove 28 mm ceramic cartridge
- GROHE AquaGuide adjustable mousseur
- swivel tubular spout
- adjustable swivel area 0° / 150° / 360°
- flexible connection hoses
- rapid installation system
- integrated temperature limiter
- maximum flow rate (at 3 bar): 6.5 l/min
- min. recommended pressure 1.0 bar
- professional exclusive

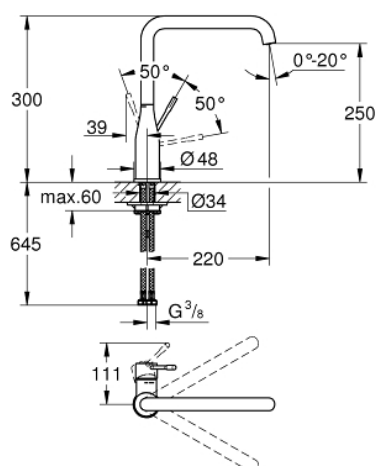

30 505 DC0 ESSENCE SINGLE-LEVER SINK MIXER 1/2"



SPARE PARTS

- 1: Lever (Spare part-nr. 46927DC0)
- 2: Cartridge (Spare part-nr. 46580000)
- 3: screw ring (Spare part-nr. 48591000)
- 4: L-spout (Spare part-nr. 13376DC0)
- 4.1: Mousseur (Spare part-nr. 48270000)
- 4.2: Sealing washer (Spare part-nr. 0128500M)
- 4.3: Safety ring (Spare part-nr. 4826600M)
- 5: Escutcheon (Spare part-nr. 48603DC0)
- 6: Shank mounting kit (Spare part-nr. 46671000)
- 7: Support plate (Spare part-nr. 05334000)
- 8: Mounting wrench (Spare part-nr. 19017000)*

* Optional accessories