

32 322 DC2 MINTA SINGLE-LEVER SINK MIXER 1/2"



PRODUCT DESCRIPTION

- Tyc: supersteel
- U-spout
- single hole installation
- GROHE Long-Life finish
- GROHE SilkMove 46 mm ceramic cartridge
- GROHE EasyDock guarantees easy retraction and smooth docking back to the starting position
- pull-out dual spray
- diverter: laminar spray/SpeedClean shower jet
- adjustable flow rate limiter
- swivel tubular spout
- swivel area 360°
- integrated non-return valve
- protected against backflow
- flexible connection hoses
- rapid installation system
- maximum flow rate (at 3 bar): 9 l/min



32 322 DC2 MINTA SINGLE-LEVER SINK MIXER 1/2"

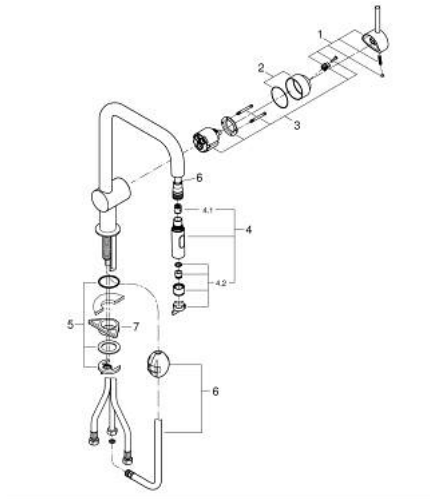

SPARE PARTS

- 1: Lever (Spare part-nr. 46015DC0)
- 2: Cap (Spare part-nr. 46025DC0)
- 3: Cartridge (Spare part-nr. 46048000)
- 4: Pull out spray (Spare part-nr. 48416DC0)
- 4.1: Non-return valve (Spare part-nr. 08565000)
- 4.2: Flow straightener (Spare part-nr. 48347000)
- 5: Shank mounting kit (Spare part-nr. 46345000)
- 6: Hose for sink mixer with pull-out dual spray or mousseur (Spare part-nr. 482 93000)
- 7: Support plate (Spare part-nr. 05334000)