

33 190 20E EURODISC COSMOPOLITAN BASIN MIXER 1/2" S-SIZE

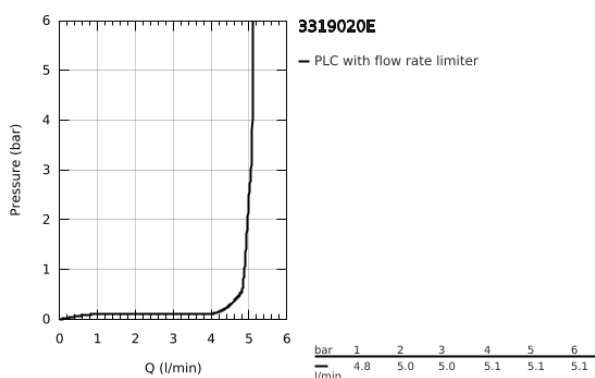
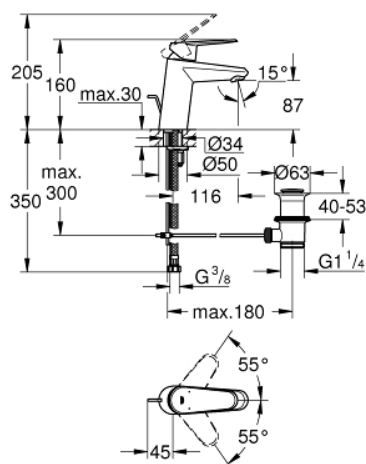

PRODUCT DESCRIPTION

- Colour: chrome
- single hole installation
- metal lever
- GROHE SilkMove 35 mm ceramic cartridge
- adjustable flow rate limiter
- adjustable minimum flow rate 2.5 l/min
- temperature limiter
- GROHE Long-Life finish
- GROHE Water Saving - Less water, perfect flow
- maximum flow rate (at 3 bar): 5 l/min
- SpeedClean mousseur
- GROHE FastFixation installation system with centering support
- pop-up waste set 1 1/4"
- flexible connection hoses
- min. recommended pressure 1.0 bar
- noise classification I in accordance with DIN 4109

33 190 20E EURODISC COSMOPOLITAN BASIN MIXER 1/2" S-SIZE

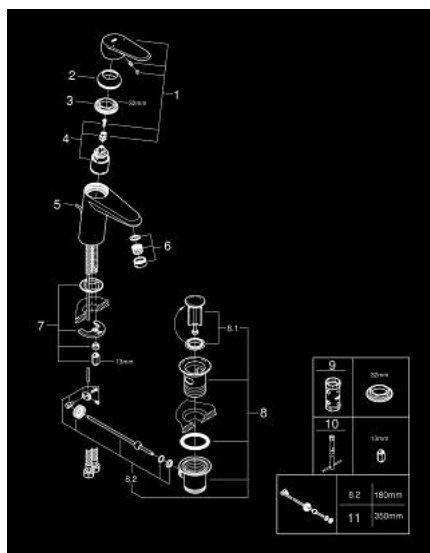

SPARE PARTS

- 1: Lever (Spare part-nr. 46738000)
- 2: Cap (Spare part-nr. 46492000)
- 3: Screw coupling (Spare part-nr. 46460000)
- 4: Cartridge (Spare part-nr. 46374000)
- 5: Pop-up rod (Spare part-nr. 46739000)
- 6: Laminar flow straightener (Spare part-nr. 13955000)
- 7: Shank mounting kit (Spare part-nr. 46645000)
- 8: Waste set 1 1/4" (Spare part-nr. 28910000)
- 8.1: Plug (Spare part-nr. 07182000)
- 8.2: Eccentric rod (Spare part-nr. 07052000)
- 9: Socket spanner (Spare part-nr. 19332000)*
- 10: Mounting wrench (Spare part-nr. 19017000)*
- 11: Eccentric rod (Spare part-nr. 07341000)*

* Optional accessories