

36 415 000 EUROSMART COSMOPOLITAN E BLUETOOTH INFRA-RED ELECTRONIC FOR CONCEALED THERMOSTATIC SHOWER

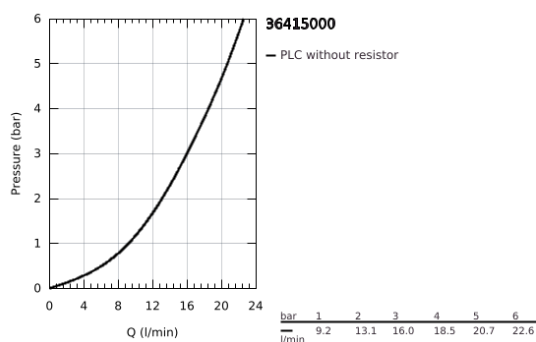

PRODUCT DESCRIPTION (1/2)

- Colour: chrome
- with infrared sensor and Bluetooth module for bi-directional communication for monitoring, configuration and service purpose
- for concealed installation box
- 36 416 001
- GROHE Long-Life finish
- chrome escutcheon
- with Bluetooth 4.0* for wireless data communication
- for Apple** and Android devices
- Bluetooth range (max. 10 m) varies depending on used materials and walls between transmitter and receiver
- monitoring
- password protected products
- app detects all Bluetooth products in range
- auto flush cycles and timing last auto flush
- usage per day over 30 days
- thermal disinfection cycles and timings last disinfection
- configuration
- shut off delay
- auto flush
- thermal disinfection
- cleaning mode
- 2 on/off timers
- identification by name
- service
- send and save 3 profiles
- reset to factory or user settings
- hard and software version
- CE approved
- Mobile devices and GROHE IR Remote App*** are not included in delivery and have to be ordered separately via an authorised Apple store/store/iTunes or Google Play store.

36 415 000 EUROSMART COSMOPOLITAN E BLUETOOTH INFRA-RED ELECTRONIC FOR CONCEALED THERMOSTATIC SHOWER

PRODUCT DESCRIPTION (2/2)

- * The Bluetooth word mark and logos are registered trademarks owned by Bluetooth SIG, Inc. and any use of such marks by Grohe AG is under license. Other trademarks and trade names are those of their respective owners.
- ** Apple, the Apple logo, iPod, iPod Touch, iPhone and iTunes are trademarks of Apple Inc., registered in the U.S. and other countries. Apple is not responsible for the function of this device or its compliance with safety and regulatory standards
- *** Available for free via iTunes app or Google Play store.

36 415 000 **EUROSMART COSMOPOLITAN E BLUETOOTH INFRA-RED ELECTRONIC FOR
CONCEALED THERMOSTATIC SHOWER**

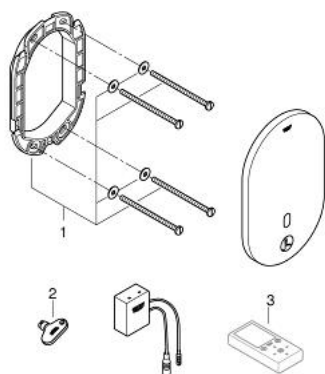

SPARE PARTS

1: Frame (Spare part-nr. 42419000)

2: key (Spare part-nr. 4823400M)

3: Remote control (Spare part-nr. 36407001)*

* Optional accessories