

## 37 751 001 TECTRON RETROFIT UNIT

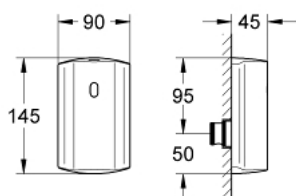

### PRODUCT DESCRIPTION

- Tyc: Chrome
- with infrared sensor for bi-directional communication for monitoring, configuration and servicing
- 6 V lithium battery, type CR-P2
- battery lifetime: approx. 7 years (150 actuations a day)
- GROHE LongLife finish
- exposed installation
- for concealed urinal flush valve 37 017 and DAL 509
- metal housing 145 x 90 x 45 mm
- solenoid valve with dirt strainer
- multistage battery status display
- 7 pre-set programs:
  - auto flush
  - cleaning mode
  - pre-flush on/off
- additional functions and precise settings by remote control 36 407
- adjustable flow time by hand or remote
- CE approved



## 37 751 001 TECTRON RETROFIT UNIT

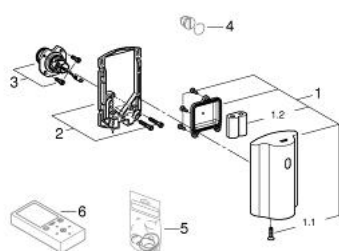

### SPARE PARTS

- 1: Housing electronic for 37 751 (Spare part-nr. 42789000)
- 1.1: Fastening screw for 37751 (Spare part-nr. 42788000)
- 1.2: Battery (Spare part-nr. 42886000)
- 2: Mounting frame for 37751 (Spare part-nr. 42790000)
- 3: Solenoid valve with strainer for 37 751 (Spare part-nr. 42791000)
- 4: Supply stop (Spare part-nr. 43392000)\*
- 5: Set of seals for 37 751 (Spare part-nr. 42792000)\*
- 6: Remote control (Spare part-nr. 36407001)\*

\* Optional accessories